

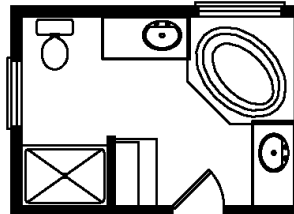

www.palmharbor.com



California



Optional Master Bath

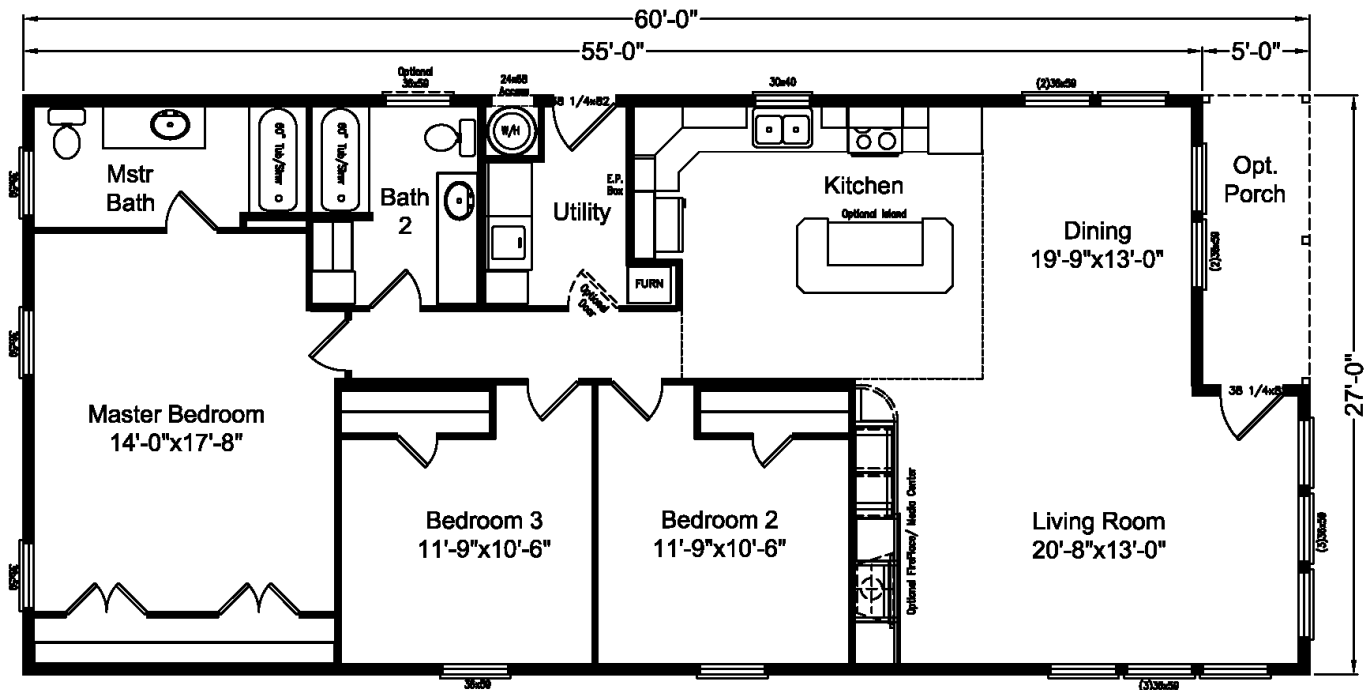

California

Model N4P360H8

4G28603E

Approx. 1552 Sq. Ft.

- 3 bedrooms, 2 baths
- Open floor plan with spacious kitchen, dining, and living area
- Master suite features large

closet with two sets of double doors

Copyright © Palm Harbor Homes, Inc. Because Palm Harbor Homes has a continuous product updating and improvement process, prices, plans, dimensions, features, materials, specifications and availability are subject to change without notice or obligation. Please refer to working drawings for actual dimensions. Renderings and floor plans are artist's depictions only and may vary from the completed home. Square footage calculations and room dimensions are approximate subject to industry standards.